



0330 606 1410
info@tlb.properties
tlb.properties

Residential | Retail | Commercial
The perfect space for you.



42 Duke Street



42 Duke Street

Retail unit to let

£615 per month
Term: 3 years

Situated within Doncaster town centre this prominent retail unit sits on the main thoroughfare linking the Waterdale and Frenchgate shopping centres.

Opposite the Colonnades. Retailers in the vicinity include McDonald's and Boyes.

Close to main road/bus routes and Doncaster Rail Station.

Available from March 2021.

42 Duke Street
Doncaster
DN1 3EA

- Ground floor retail unit suitable for a variety of uses
- Open plan design with large shop floor to the front
- Secure off-road parking space to the rear
- Air conditioned
- Excellent signage opportunities

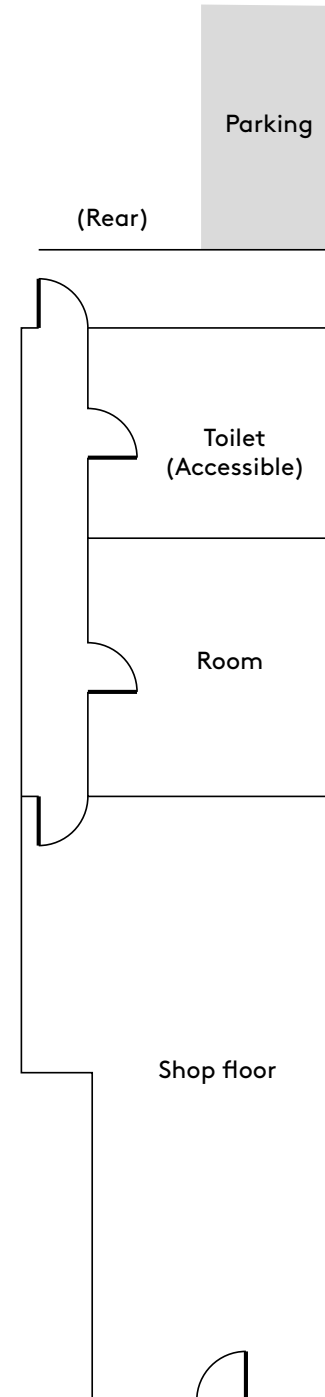

Ground floor
517 sq ft

Text, plans and images are for guidance only. Plans are not to scale and any dimensions, areas or distances given are approximate. Business rates are not included. All prices are subject to VAT.